

Pulleys

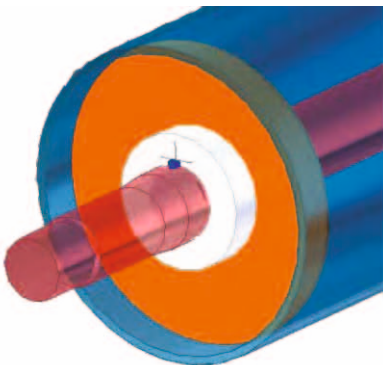

NORMAL DUTY

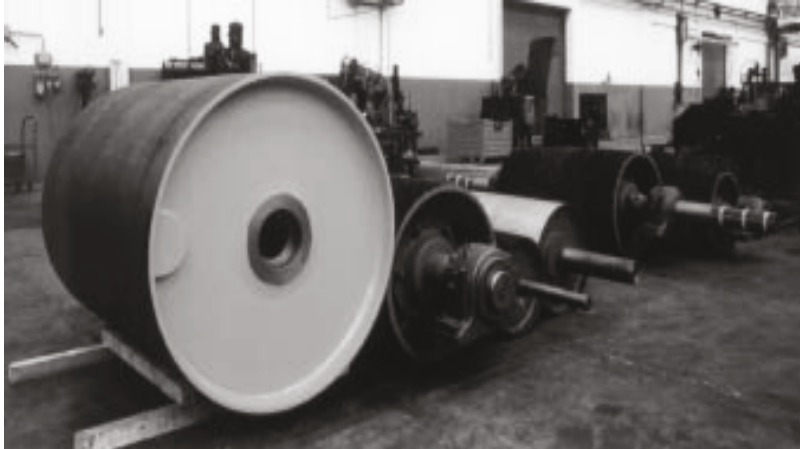
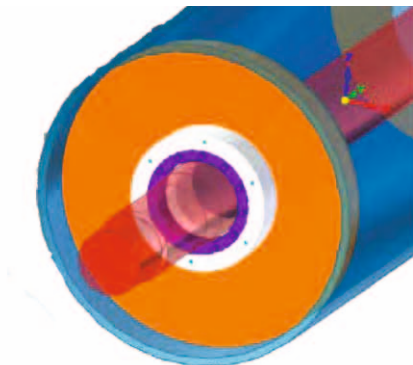

HEAVY DUTY



EXTRA HEAVY DUTY

TECHNICAL SPECIFICATIONS

- Conveyor capacity range upto 4000 TPH.
- Belt width upto 2200 mm.
- Belt speed upto 3.85 ml sec.
- Shaft dia @ hub upto 340 mm
- Pulley dia upto 1250 mm.

Pulley category :

- | | |
|--------------------------------------|--|
| Shaft dia at hub \leq 160 mm | ◦ Normal duty |
| 160 < shaft dia at hub \leq 240 mm | ◦ Heavy duty |
| 240 < shaft dia at hub | ◦ Extra heavy duty pulley (Turbo pulley) |

SPECIAL RANGE

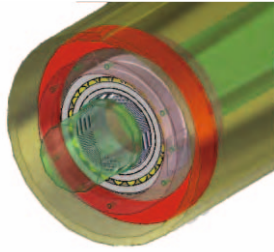

STATIC SHAFT DESIGN



STUB PULLEY DESIGN

Pulleys are dimensioned according to the characteristics of each conveyor and may be designed to meet a great variety of construction methods.

For 40 years TRF has designed and manufactured pulleys, using materials of the highest quality in a production process employing advanced technology. This together with the application of the Quality Assurance system certified to ISO 9001 contributes to the production of high quality products offering dependable, long life performance in the field and appreciably reducing maintenance costs.

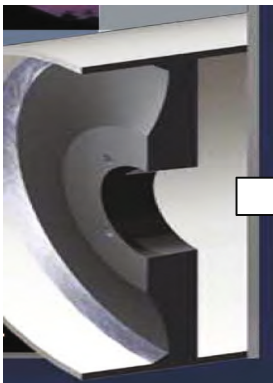
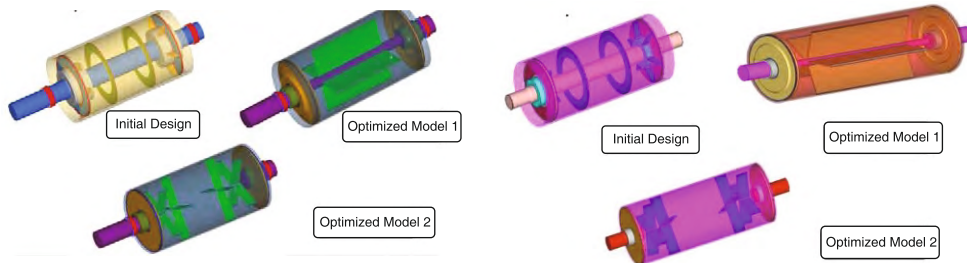

The images below illustrate the varied level of stress concentrations induced on three pulley configurations while they experienced loads of equal amounts. Widespread, consistent, blue and green coloration would indicate a low risk of stress induced failure

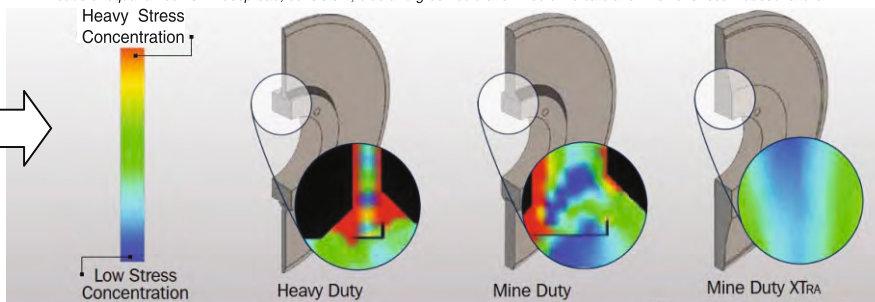

Stress concentration

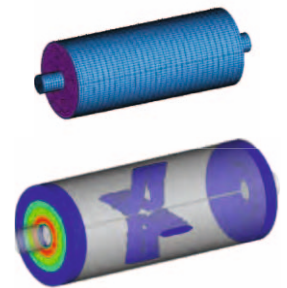

Finite Element Analysis

HEAD OFFICE & WORKS

TRF Limited

11, Station Road Burma Mines, Jamshedpur-831007, Jharkhand
Phone : +91-657-2345721, e-mail : lcs@trf.co.in
Website : www.trf.co.in